

Land Act 1994

TAKING OF LAND ORDER (No 01) 2010

Short title

1. This notice may be cited as the *Taking of Land Order (No 01) 2010*.

Land taken [s.216 of the Act]

2. The land described in the Schedule is taken by the State on behalf of Cook Shire Council for Road purposes on and from 12 March 2010.

SCHEDULE

North Region, Cairns Office

Land Taken

Lots 1 to 4 and 6 to 13 on SP208316 (to be registered in the Land Registry), areas about 21.7 ha, about 54.7 ha, about 1.86 ha, about 4700 m², about 29 ha, about 7.15 ha, about 41.5 ha, about 111 ha, about 2.7 ha, about 28.6 ha, about 14 ha, about 5.55 ha respectively, parts of Palmerville Pastoral Holding No 14/5422, Title Reference 17666154, parishes of Combar, Hurford, Jessop and Palmerville.

ENDNOTES

1. Made by the Governor in Council on 11 March 2010.
2. Published in the Gazette on 12 March 2010.
3. Not required to be laid before the Legislative Assembly.
4. The administering agency is the Department of Environment and Resource Management.
5. File Reference – L.A.B. 11338

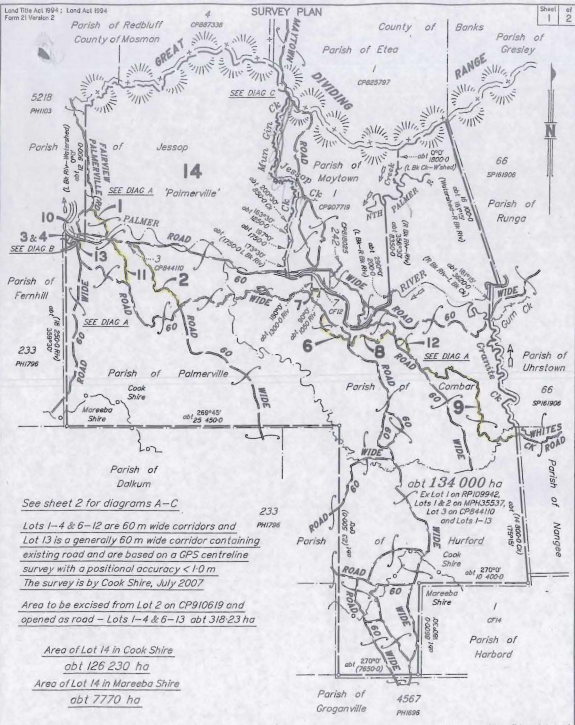

See sheet 2 for diagrams A-C

Lots 1-4 & 6-12 are 60 m wide corridors and Lot 13 is a generally 60 m wide corridor containing existing road and are based on a GPS centreline survey with a positional accuracy < 1.0 m
The survey is by Cook Shire, July 2007

Area to be excised from Lot 2 on CP910619 and opened as road - Lots 1-4 & 6-13 abt 318'23 ha

Area of Lot 14 in Cook Shire
abt 126 230 ha

Area of Lot 14 in Mareeba Shire
abt 7770 ha

I, Ian Van Den Bergh hereby certify that I have made this plan pursuant to the Survey and Mapping Infrastructure Act 2003 and Surveyors Act 2003 and associated Regulations and Standards and that the plan is accurate, and compiled from CP825797, CP910619, CP8, MPH35537, SP161906 and Cook Shire GPS survey in the Department of Environment and Resource Management



...s.2008 Date

<p>Plan of Lots 1-4 & 6-14</p> <p>Cancelling Lot 2 on CP910619</p>		<p>Scale: 1:200 000</p> <p>Format: STANDARD</p> <p>SP208316</p> <p>Plan Status:</p>
<p>PARISH: AS SHOWN</p> <p>Meridian: Approx CAM vda CP910519</p>	<p>COUNTY: Chelmsford</p> <p>F.N.C. -</p>	

DIAGRAM A
Scale - 1:125 000

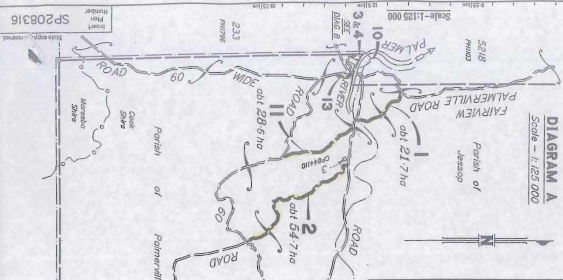

DIAGRAM B
Scale - 1:20 000

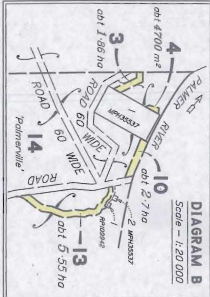
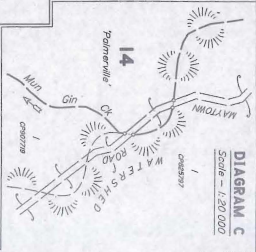

DIAGRAM C
Scale - 1:20 000



ADDITIONAL SHEET

Land Title Act 1994 - Land Act 1994
Form 21 Version 2

**WARNING : Folded or Mutilated Plans will not be accepted.
Plans may be rolled.
Information may not be placed in the outer margins.**

(Dealing No.)

Registered

s. Lodged by

(Include address, phone number, references, and Ledger Code)

i. Certificate of Registered Owners or Lessees.

I/We _____

Existing			Created		
Title Reference	Lot	Plan	Lots	Emis	Road
17666154	2	CP910619	1-4 & 6-14	-	-

(Names in full)

*as Registered Owners of this land agree to this plan and dedicate the Public Use Land as shown hereon in accordance with Section 50 of the Land Title Act 1994.

*as Lessees of this land agree to this plan.

Signature of *Registered Owners *Lessees

* Rule out whichever is inapplicable

ii. Local Government Approval.

*
I hereby approve this plan in accordance with the:
%

PH5422

1-4 & 6-14

City

Lots

7. Portion Allocation :

a. Map Reference:

7765-14333

12. Building Format Plans only.

I certify that:
* As far as it is practical to determine, no part of the building shown on this plan encroaches onto adjoining lots or roads.
* Part of the building shown on this plan encroaches onto adjoining * lots and road.

Registrar/Surveyor/Director * Date

* Date words not required

9. Locality:

Palmer

10. Local Government:

Cook Shire Council

13. Lodgement Fees:

Survey Deposit \$ _____
Lodgement \$ _____
..... New Titles \$ _____
Photocopy \$ _____
Postage \$ _____
TOTAL \$ _____

11. Passed & Endorsed:

By: D.E. F.M.

Date: 14-09-2009

Signed: *[Signature]*

Designation: CAMERON SURVEYOR

14. Insert Plan Number

SP208316

* Insert the name of the Local Government. * Insert Integrated Planning Act 1997 or Local Government (Planning & Environment) Act 1990

3. Plans with Community Management Statement:

CMS Number:

Name:

4. References:

Dept File:

Local Govt:

Surveyor: